

**MUSHROOM PUSH BUTTON SWITCH
R950 SERIES- PUSH TO LOCK
R952-PTL**

R950 SERIES
STAINLESS STEEL / BRASS
FACE PLATE

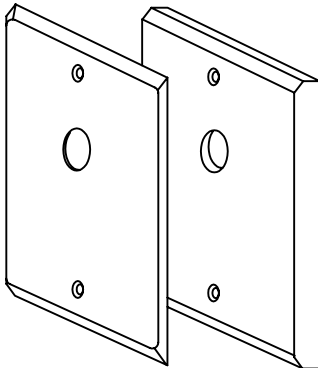

R950SP series
1/4" aluminum faceplate

R950N NARROW STYLE SERIES
STAINLESS STEEL / BRASS
4-1/2 X 1-3/4 FACE PLATE

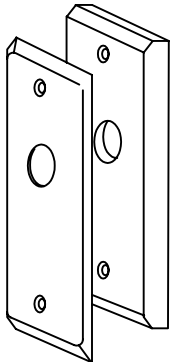

R950SPN NARROW STYLE SERIES
4-1/2 X 1-3/4" X 1/4" aluminum faceplate

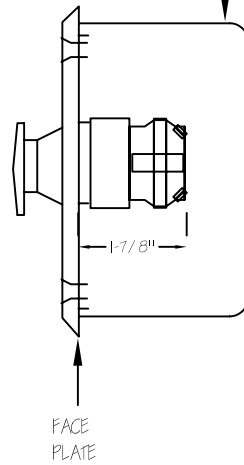
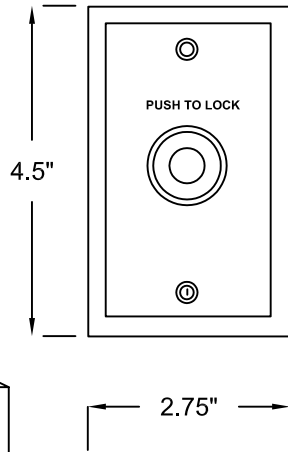

SWITCH SPECIFICATIONS:
1 NORMALLY OPEN
1 NORMALLY CLOSE
CONTACT RATING :600VAC - 10 AMP
250VDC - 0.25 AMP
125VDC - 0.5 AMP

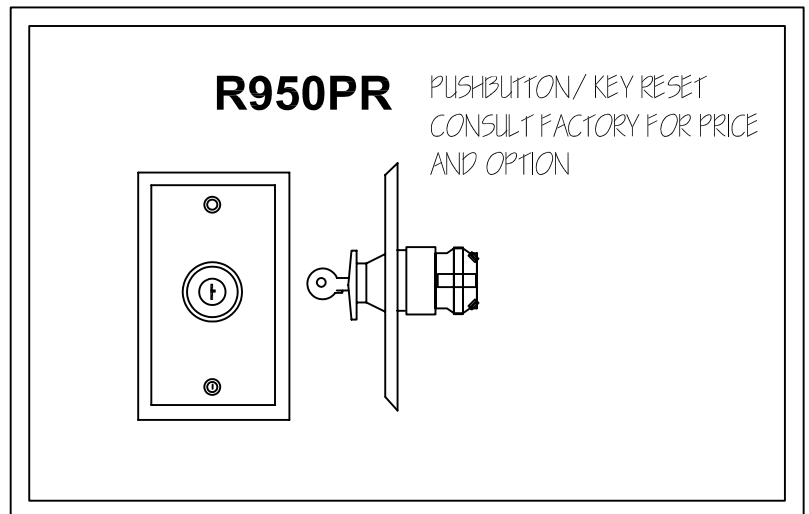

MODEL NO: REGULAR FACE PLATE (STAINLESS STEEL)

R-952 - MOMENTARY MUSHROOM PUSH BUTTON SWITCH
1-N/ OPEN, 1 N/ CLOSE CONTACT

MODEL NO: SP SERIES (ALUM FACE PLATE)

R952SP - MUSHROOM MOMENTARY PUSH BUTTON SWITCH
1 N/ OPEN, 1 N/ CLOSE CONTACT

OPTIONS
LG - GREEN LED,
LR - RED LED,
LGR - ONE GREEN & ONE RED LED,
SUFFIX "D" - FOR DPDT SWITCHES
SUFFIX "N" - FOR NARROW STYLE
EXIT - LABEL "EXIT"



ASTERISK SECURITY
HARDWARE INTERNATIONAL INC.
7045 Tranmere Drive
Unit 10
Mississauga, Ontario
Canada L5S 1M2

**ASTERISK SECURITY HARDWARE INTERNATIONAL INC
MUSHROOM PUSHBUTTON SWITCHES - R950 SERIES**